

# LED MULTIFUNCTIONAL WORKING LIGHT

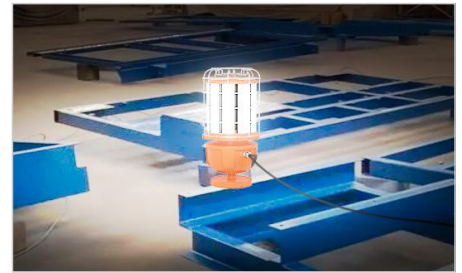

**MODEL: BB-HJD-XXXW-Q4**



**Strong magnetic force**  
Install on the iron



**U clamp**  
Adjustable steel clamp



**Floor stand**  
Durable metal floor stand

## ► Features

What makes it unique is its versatility. Use it as task lighting on a tripod to illuminate an entire room. Clamp it to scaffolding on skyscrapers. Place it on a metal beam in an attic. Even daisy-chain it as part of the LED Jobsite System for large area lighting. Whatever your project lighting needs will meet it. Illuminating brightness Large range, high brightness, long range, long life of the bulb, The average service life is more than 50000 hours. Stainless Steel guard outdoor emergency lighting plug-in-Play. Die cast aluminum lamp body. Air convection design between up and down of the lamp, promoting the heat dissipation function so that could ensure the lamp lifespan with a variety of installation. Optional: tripod installation, chain installation, suspension installation, magnet installation, The luminaire could be linkable (80W max link 9pcs; 100w max link 7pcs; 120W max link 6pcs; 150W max link 5pcs.)

- ✓ 1. Beam angle: 360 degrees.
- ✓ 2. Aluminum heat sinks and active air exchanging cooling system in order to speed up heat dissipation.
- ✓ 3. It's major to replace the CFL/MH/HID/HPS.
- ✓ 4. Green, energy saving, long and reliable life of 50,000 hours.
- ✓ 5. No RF interference, No IR/UV radiation, no mercury pollution.
- ✓ 6. Streamline exterior design, beautiful appearance.
- ✓ 7. Environment friendly, energy saving (70-80%).
- ✓ 8. Special circuit design, each LED works separately, avoiding the single broken LED influence problem.
- ✓ 9. Mounting options can be easily changed with no special tools.

## ► Product picture



1. Suspension loop

- Chain suspension mounting



2. Lifting hook

- Easy to install, flexible installation



3. Floor stand

- With floor stand, Put it on the floor



4. U clamp

- With clamp mount, Clamp the lamp to the pole.



5. Magnetic bracket

- Install on the iron items any Angle



6. Portable bracket

- Hold by hand or install on the board/wall.



7. Ceiling mounting

- Fixed on ceiling/wall /concrete floor

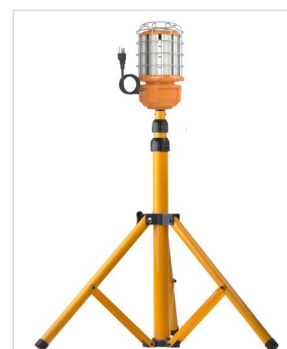

8. With 4-8' tripod

- High and low adjustment

## DATA SHEET

Power	80W	100W	120W	150W
Model	BB-HJD-80W-Q4	BB-HJD-100W-Q4	BB-HJD-120W-Q4	BB-HJD-150W-Q4
Luminous Flux	12000lm	15000lm	18000lm	22500lm
Replacement	HPS 250W	HPS 300W	HPS 350W	HPS 400W
Light Source	2835 SMD LED			
Luminous Efficacy	≥150lm/w			
Options	1.The connector is optional. 2.With emergency power(After the power failure, make sure the lamp can still work for 1.5h).			
Operation Temp.	-40 to +45°C			
CCT	2700K SW / 3000K WW / 4100K NW / 5000K DW / 5700K CW / 6500K SCW			
CRI	80+			
Life Span	50,000 hours at 25°C			
Voltage	100-277VAC/50-60Hz      200-480VAC/50-60Hz available			
Driver	Internal Power Supply.Emergency power supply is optional			
Dimming	Standard: Not dimmable;      Dimmable optional.			
Sensor	Standard: No sensor;      Microwave sensor optional.			
Remote Control	Standard: No remote;      Remote control optional.			
Beam Angle	360°			
Cover	Transparent cover(default)			
Lamp Base	1.Suspension loop 2.Lifting hook 3.Floor stand 4.U clamp 5.Magnetic bracket 6.Portable bracket 7.With 4-8' tripod			
PF	>0.95			
Warranty	5Years			

### ► Model Nomenclature

Model:BB-HJD-XXXW-Q4-ABC-EFGH-I,For example:BB-HJD-80W-Q4-LD-27K90BLE-3

Electric Character			Optics Character				Physical Character
A	B	C	E	F	G	H	I
Power	Input voltage	Dimming	CCT	CRI	LED CHIP	Emergency power supply	Installation
80W 100W 120W 150W	L-100-277V H-200-480V	Blank-No Dim D-Dimmable	27K-2700K 30K-3000K 40K-4000K 50K-5000K 57K-5700K 65K-6500K	70-Ra70 80-Ra80 90-Ra90	Blank-2835 LED	Blank-Without E-Emergency power supply	1.Suspension loop 2.Lifting hook 3.Floor stand 4.U clamp 5.Magnetic bracket 6.Portable bracket 7.With 4-8' tripod



## ► Application case

Temporary lighting, engineering decoration, outdoor temporary lighting and so on



## ► Surface Of Intensity Distribution

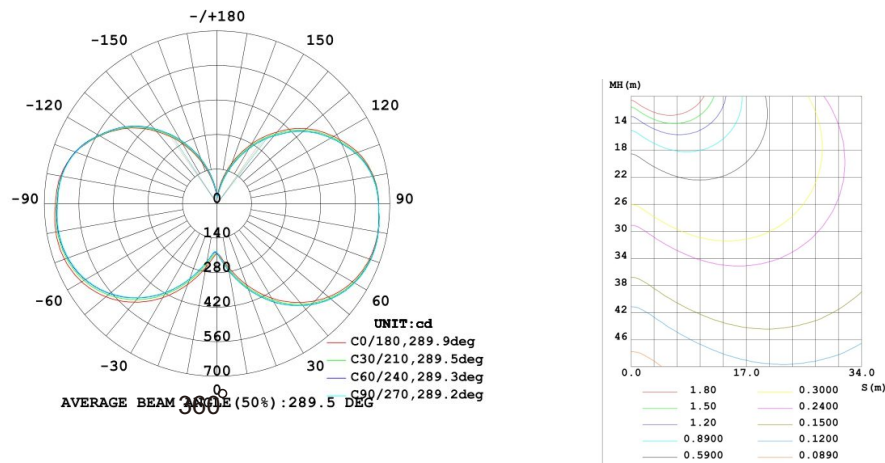

## ► Dimension

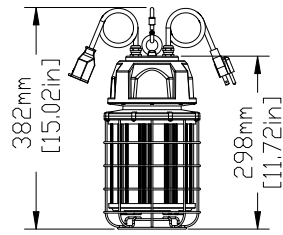

1. Suspension loop

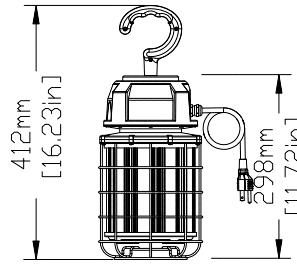
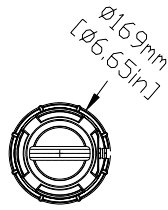

2. Lifting hook

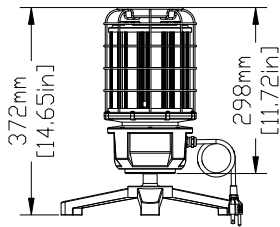
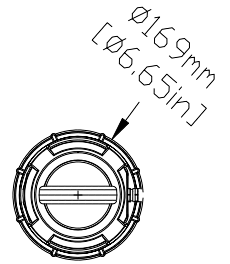

3. Floor stand

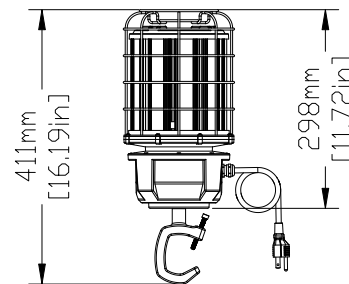
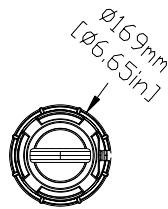

4. U clamp

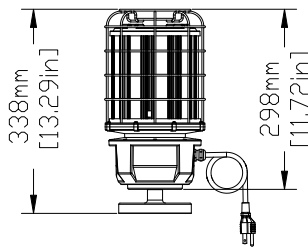
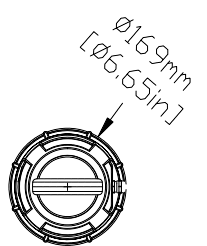

5. Magnetic bracket

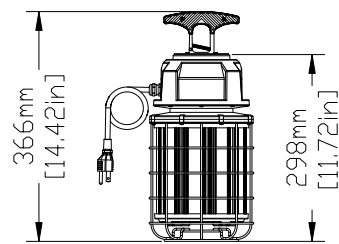
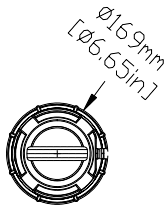

6. Portable bracket

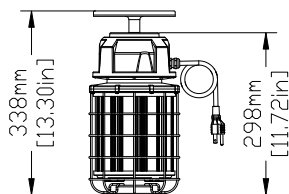
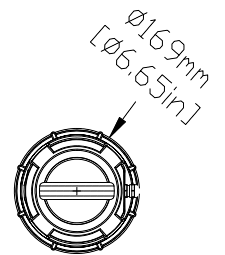

7. Ceiling mounting

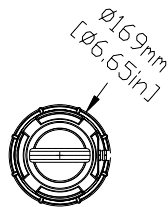

## ▶ Plug

Plug can be optional as required ,Please contact sales.

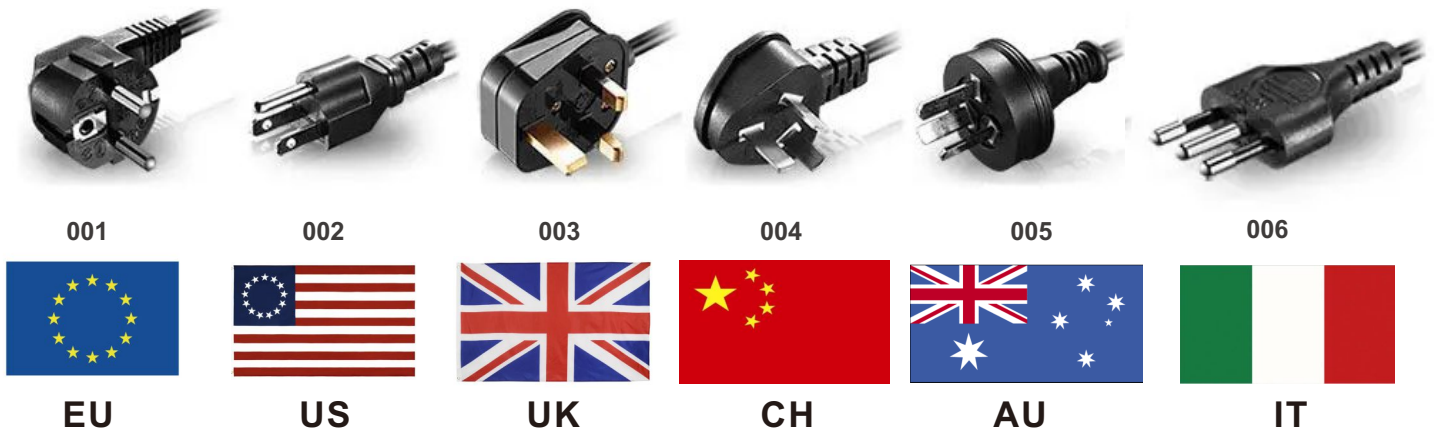

## ▶ Tripod Stand

Tripod stand is optional(Adjustable height 0.6m~1.6m).

Customers can choose according to their needs.If necessary, please contact sales.

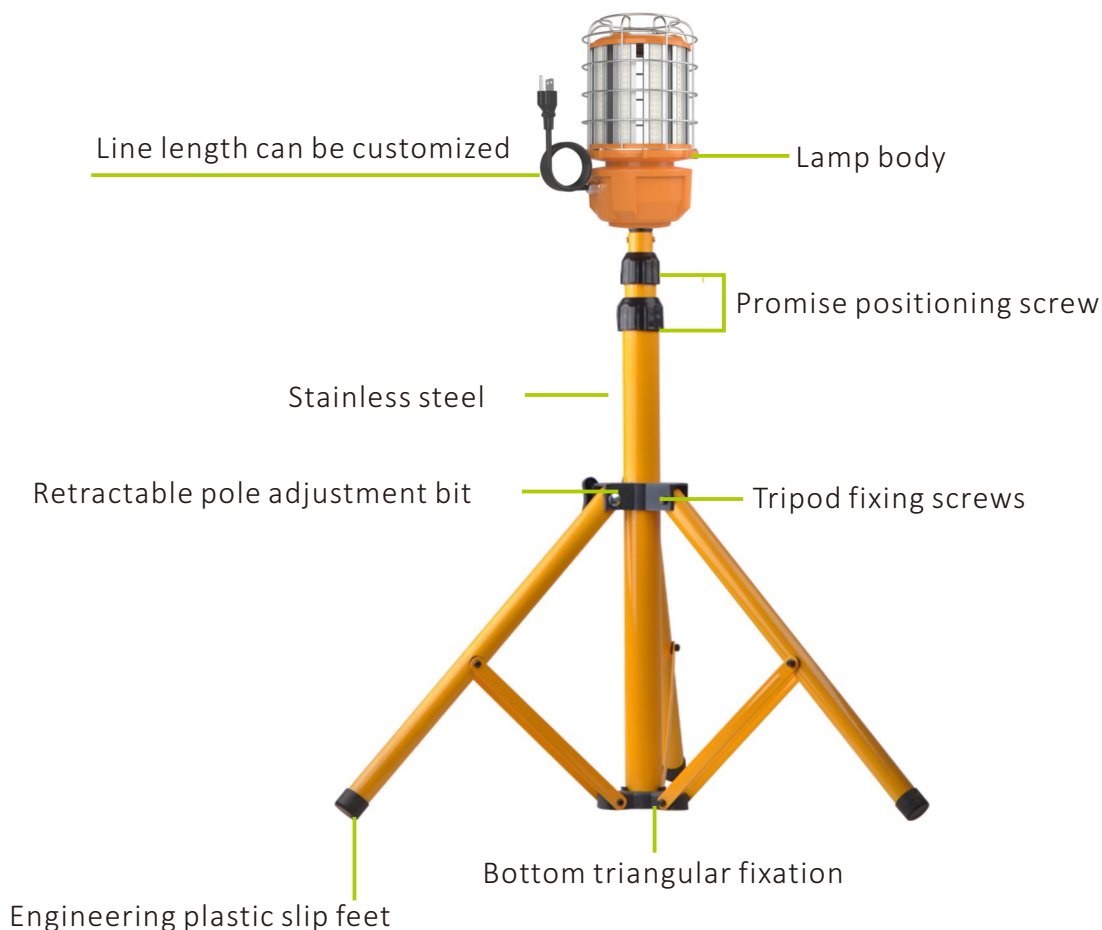

## ► With Connector

For 80~150W lamp, the connector is optional. Customers can choose according to their needs.

If necessary, please contact sales.



Lamp1

Lamp2

Lamp3

And more...

- The luminaire could be linkable series data table

Power	Voltage	Max Link Qty	Voltage	Max Link Qty	Voltage	Max Link Qty
150W	110V	5PCS	230V	10PCS	277V	12PCS
120W	110V	6PCS	230V	13PCS	277V	16PCS
100W	110V	7PCS	230V	16PCS	277V	19PCS
80W	110V	9PCS	230V	20PCS	277V	24PCS
60W	110V	12PCS	230V	26PCS	277V	32PCS
40W	110V	19PCS	230V	40PCS	277V	48PCS

## ► Packing info

Items	Packaging	Carton Size(mm) (L*W*H)	N.W	G.W	Volume weight
80W	6pcs/CTN	610*430*420mm	13.4kg	14.5kg	22.0kg
100W	6pcs/CTN	610*430*420mm	14.2kg	15.3kg	22.0kg
120W&150W	6pcs/CTN	610*430*420mm	15.8kg	16.9kg	22.0kg
Tripod Stand	1pcs/CTN	620*100*100mm	2.6kg	3.5kg	2.5kg
	12pcs/CTN	640*330*420mm	42.0kg	43.0kg	22.0kg

